

# INSTALLATION MANUAL

**CRABLE.CO.UK**



# CONTENTS

<b>MODEL DETAIL &amp; TECHNICAL DATA</b>	<b>03</b>
<b>OVERVIEW</b>	<b>04</b>
<b>IMPORTANT INFORMATION</b>	<b>04</b>
<b>EN</b>	<b>05</b>
<b>INSTALLATION</b>	<b>06</b>
<b>INSTALLATION DIAGRAMS</b>	<b>07</b>

# MODEL DETAIL

(MODEL NO(S): HTL-CL-0619)

(SERIAL NO(S): \_\_\_\_\_)

AC/DC CONVERTER	AC INPUT DC VOLTAGE RATED CURRENT ISOLATION NO LOAD POWER CONSUMPTION	80-264VAC 100-370VDC 12V 1660mA CLASS II <0.1W
INTERNAL FUSE	RATED CURRENT	15A @ 250VAC 72VDC

 **MADE IN BRITAIN®**

3

INSTALLATION MANUAL  
BY CRABLE LTD

CRABLE.CO.UK



# OVERVIEW

## WHAT IS A SHELF STATION?

A pre-configurable localised power (and data) solution – achieved by housing a range of Euro DIN modules within in a strong Polycarbonate / ABS plastic Wall Mounted 'Shelf';

Configured at point-of-order (or retro-fit), the Shelf Station's modular design will accommodate various power outlets, power adapters, a switched light source, wired and wireless media charging alongside data.

For the full range of replaceable Euro DIN modules visit [www.crable.co.uk](http://www.crable.co.uk)

**Only qualified and trained personnel familiar with this type of product and who fully understand these instructions should install, connect or test this equipment.**

*There are no user serviceable parts within the enclosed power supply unit.*

The equipment is intended for indoor use only in dry locations.

The installation must meet National Wiring Regulations and IEC60950-1 standards.

## READ THE INSTRUCTIONS BEFORE INSTALLING & POWERING THE EQUIPMENT.

A readily accessible disconnect device shall be incorporated in the building wiring to include an appropriately rated circuit breaker.

After switching off, all internal capacitors will discharge to safe levels within 60 seconds under normal conditions. Under fault conditions, charge may be held for much longer and suitable precautions should be taken before handling the unit.

### IMPORTANT INFORMATION

All warranties are invalid if this product is not installed by a competent person. Keep the instructions in a safe place for future reference.

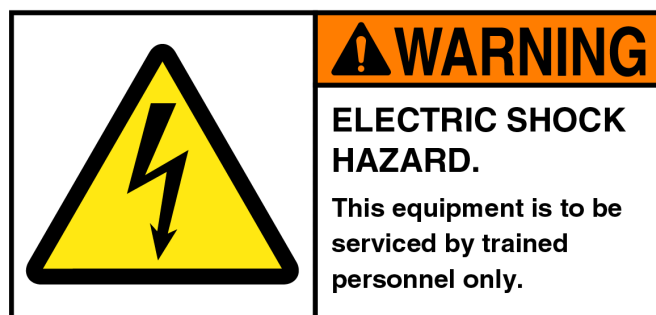

## PREPARATION

### Location

We designed the SHELF STATION to be mounted on a wall, near a bed, table or work area – exactly where is up to you, but we recommend that you decide the position and mark it with measurements from fixed references in the room such as the floor or wall. (Figures 1 - 3). The SHELF STATION conceals the electricity supply outlet. Figure 4 shows the outlet location relative to the SHELF STATION wall bracket outline.

### Mounting

Each SHELF STATION requires 4 (four) PAN HEAD mounting screws. Ensure the screw thread diameter and head sizes are as shown in figure 5). If any screw features are larger than shown, the installation may fail,

**DO NOT USE COUNTERSUNK SCREWS.**

THE CRABLE SHELF STATION is a shelf, so the wall and the fixings should be strong enough to mount a shelf. The installer must choose screw & wall plug types to suit the wall composition, remembering the maximum sizes. (Examples: figures 6 & 7)

A paper template (supplied) helps the professional installer position the electricity supply and mounting holes.

Mark out positions for the four mounting screws and electricity supply. The shape of the opening for the electricity supply should suit the connection device you choose to connect the SHELF STATION to the supply. (Figures 8 & 9)

### Electricity supply

- The Shelf Station requires a 13amp fused supply with isolation
- The connection device should be suitably rated to connect the SHELF STATION's Live, Neutral and Earth wires to this supply.

Recommend using a 13amp Fused Spur Connection Unit (unswitched) with flex outlet (Figure 13)

Or if using a remote 13amp fused spur then an enclosed 15A 3way Screw Terminal Connector (Chocolate block) (Figure 14) can be used.

- We recommend fitting a double pole isolator switch between the terminal and the mains, sized to the load and compliant with current regulations.

# INSTALLATION

## INSTRUCTIONS

Make suitable holes for the screws and wall plugs, and make a suitable opening for the electrical terminal (Figure 10)

Route an electrical supply within the wall.  
(Figure 11)

Mount the SHELF STATION wall bracket to the wall using suitable screws. (Figure 12)

Position the SHELF STATION near the wall and connect the electrical supply lead to the flex outlet or terminal block. Figure 13 shows a terminal with a faceplate. If access to faceplate screws access is blocked, cut off the H-shaped web as required. Figure 14 shows a terminal block without a faceplate.

1. Push the connected SHELF STATION body into position over the wall bracket. Make sure the flying lead is not trapped. (figure 15)
2. Slide the SHELF STATION body down the wall bracket. Fit the two security screws as shown. (figure 16)

Congratulations! The SHELF STATION is now installed.

# DIAGRAMS & TECHNICAL DATA

# DIAGRAMS & TECHNICAL DATA

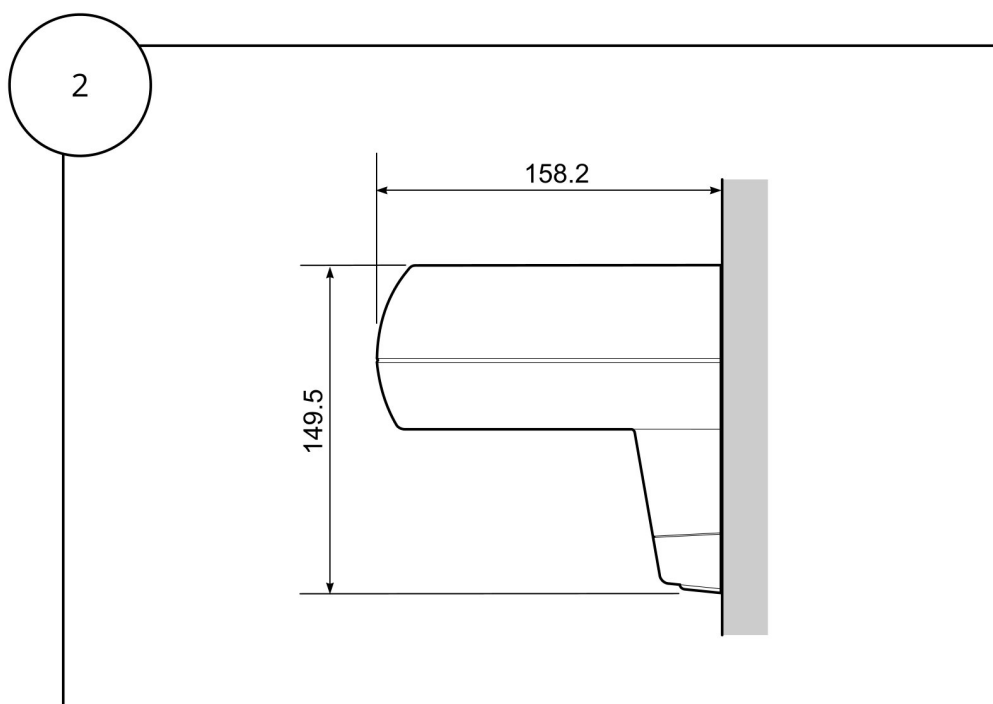
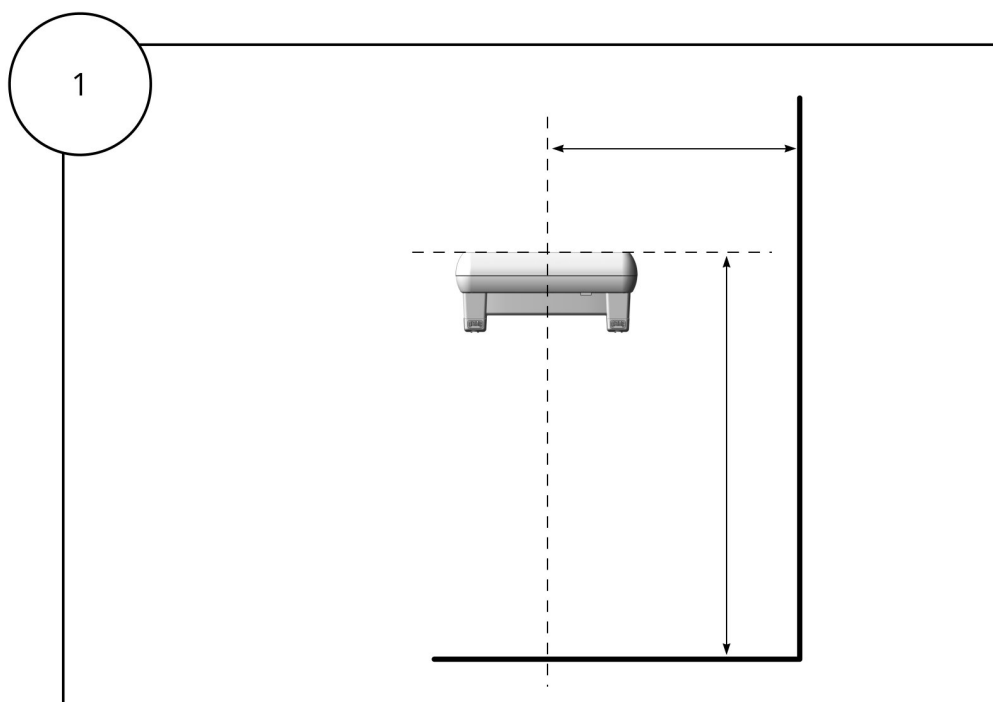



# DIAGRAMS & TECHNICAL DATA

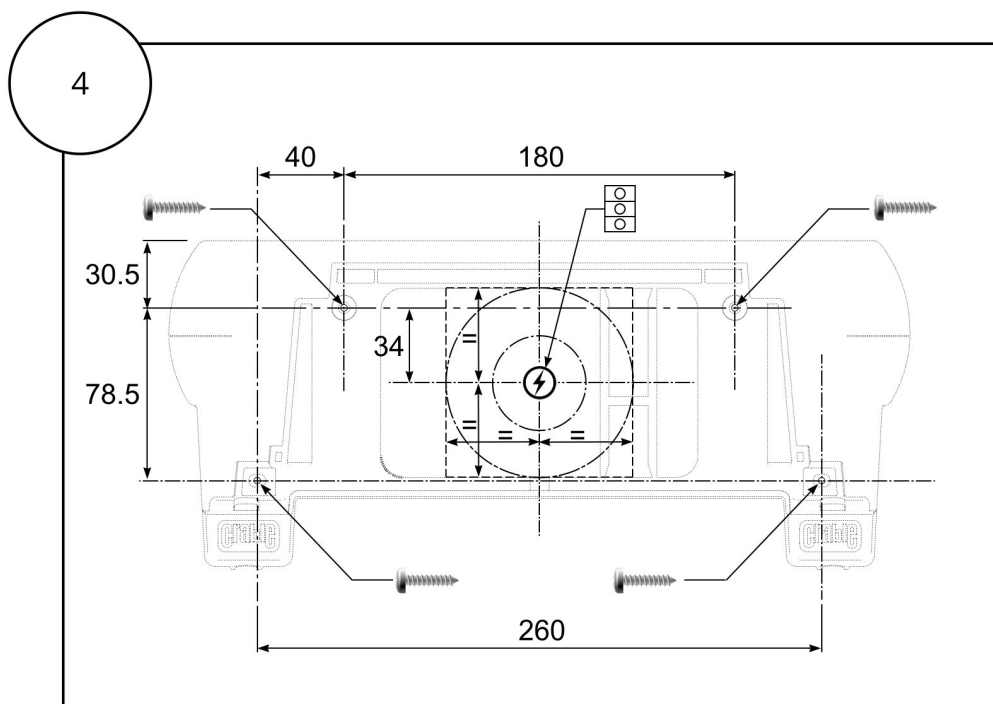
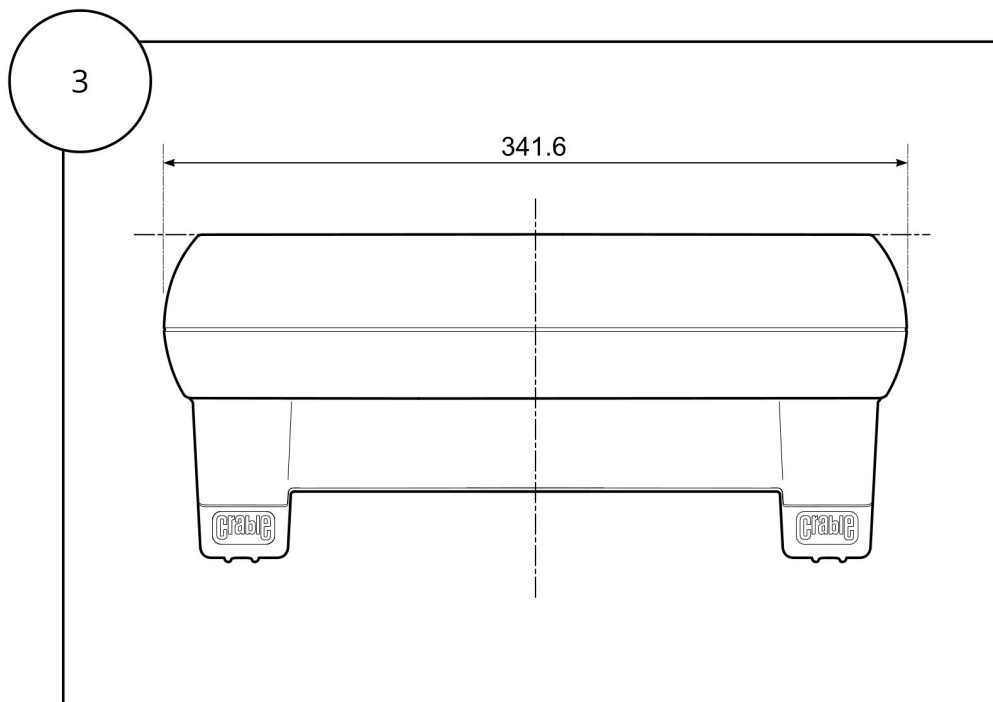

## DIAGRAMS & TECHNICAL DATA

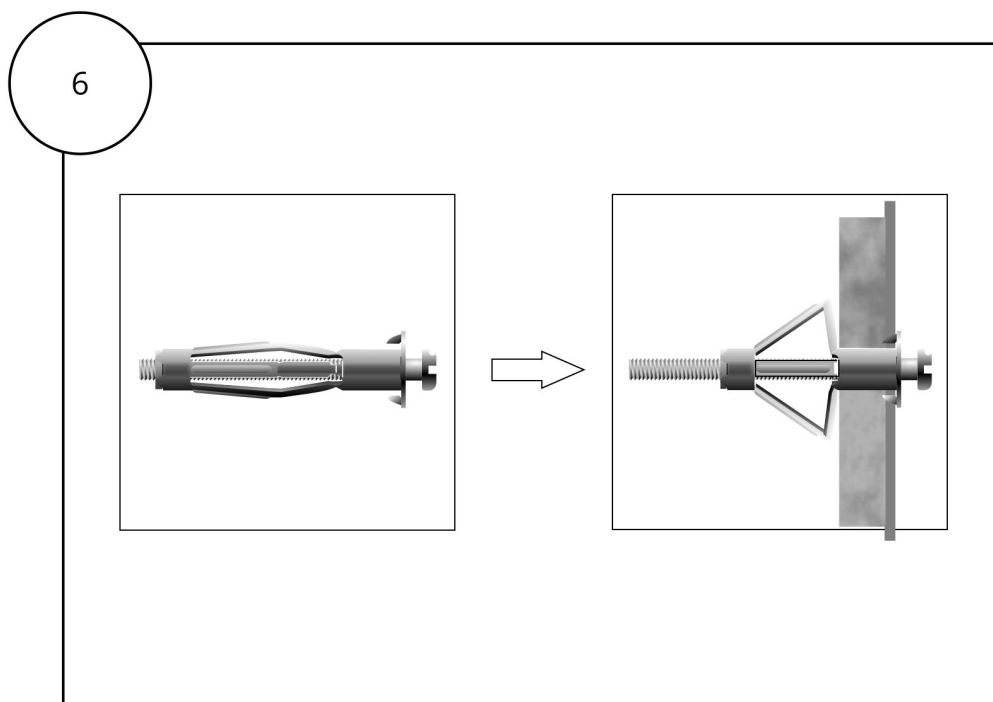
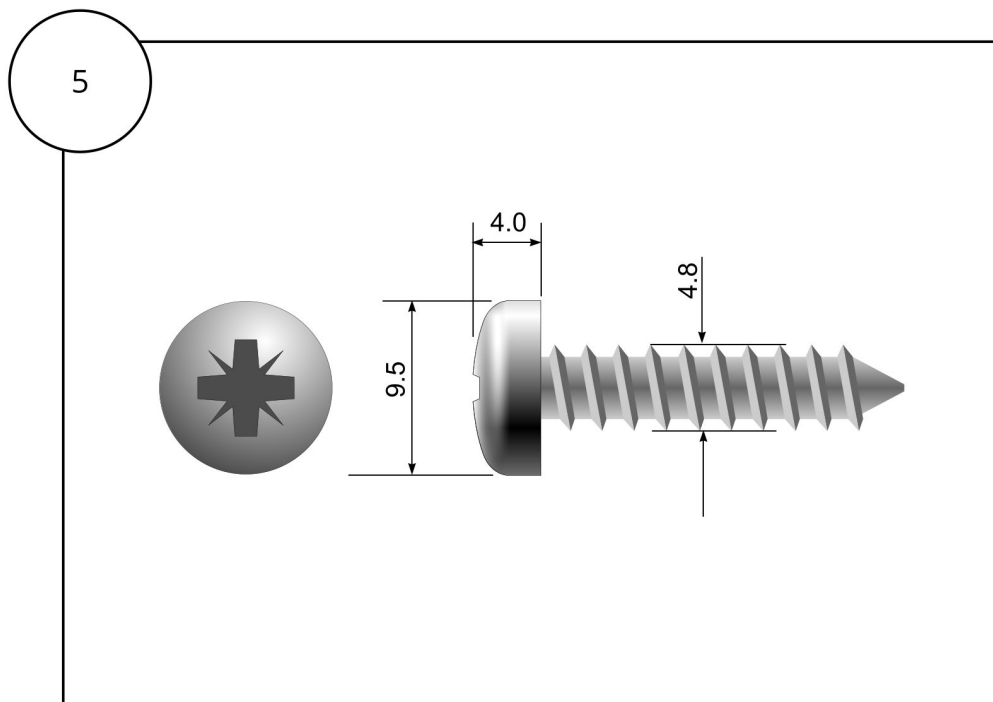

## DIAGRAMS & TECHNICAL DATA

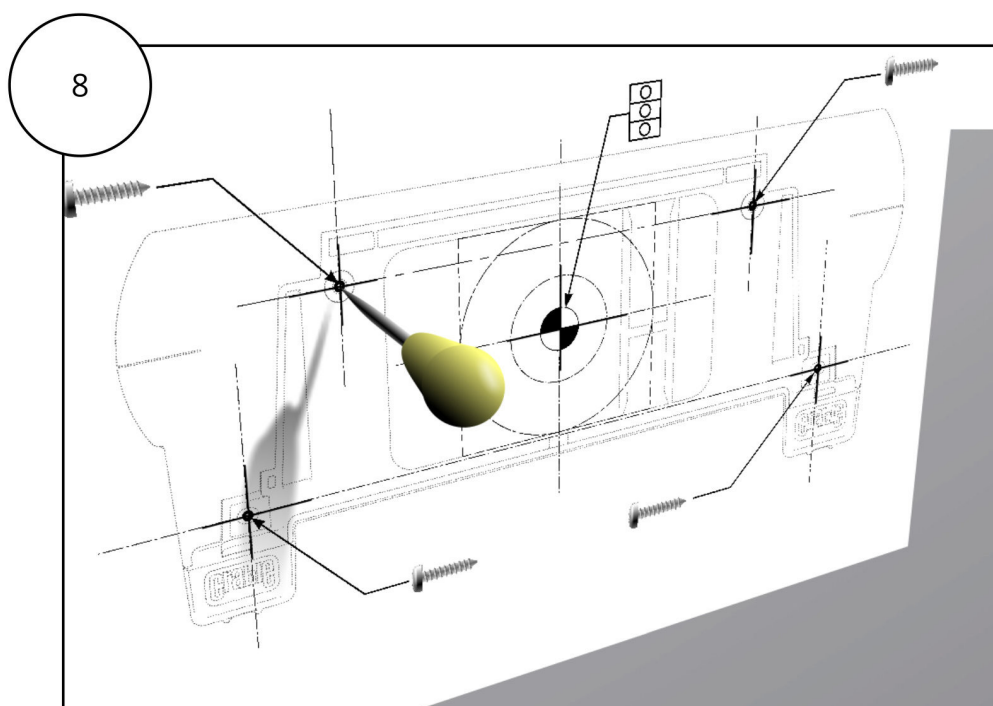
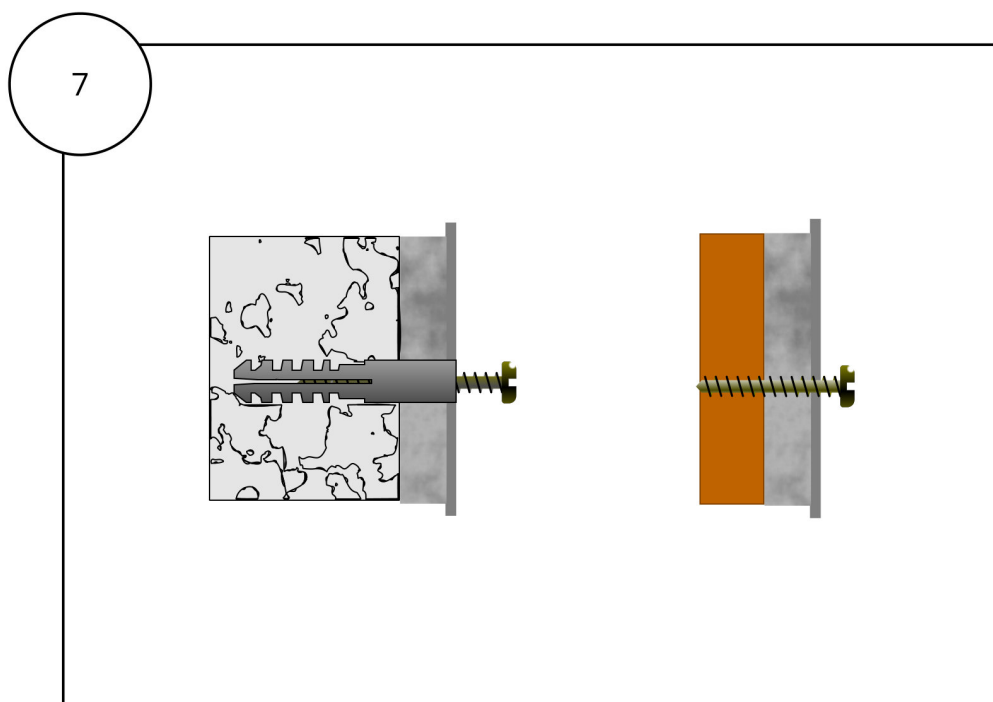

## DIAGRAMS & TECHNICAL DATA

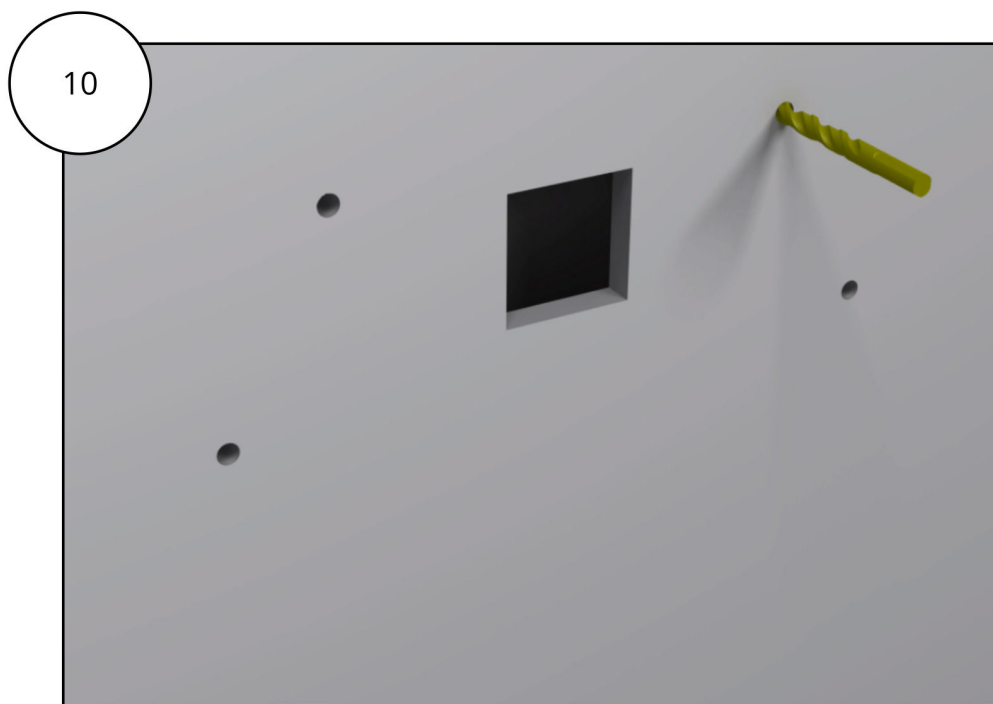
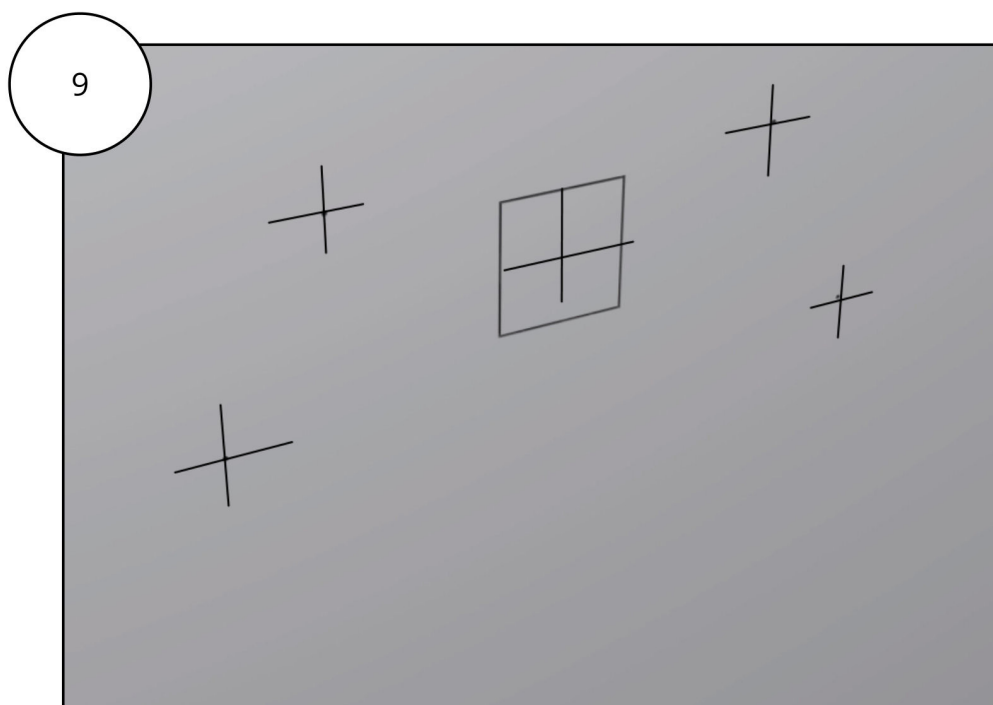

## DIAGRAMS & TECHNICAL DATA

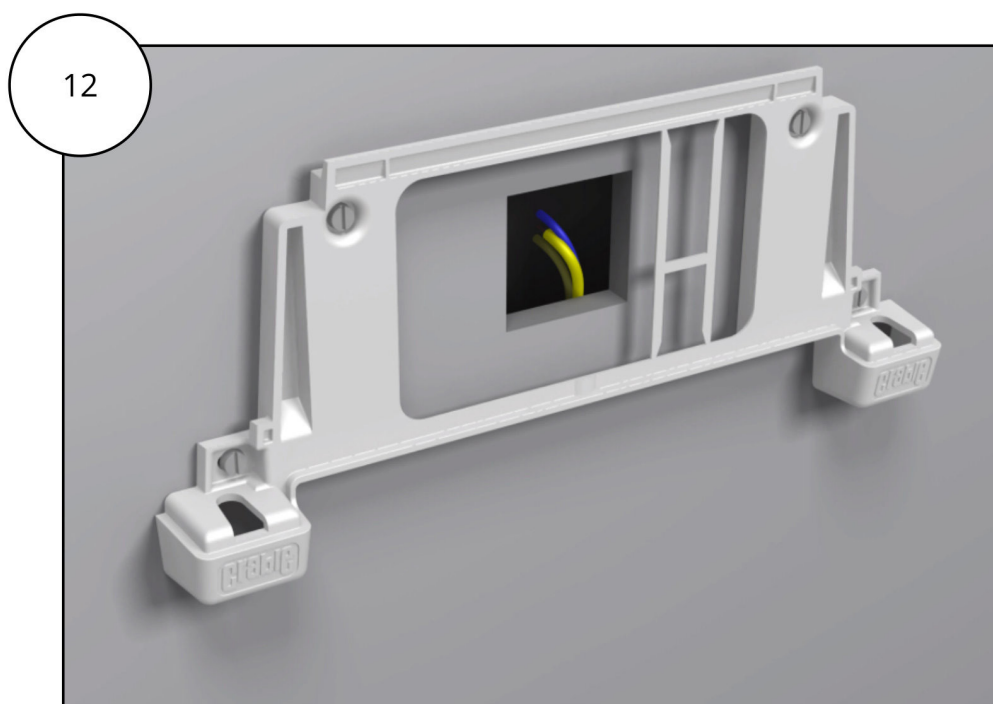
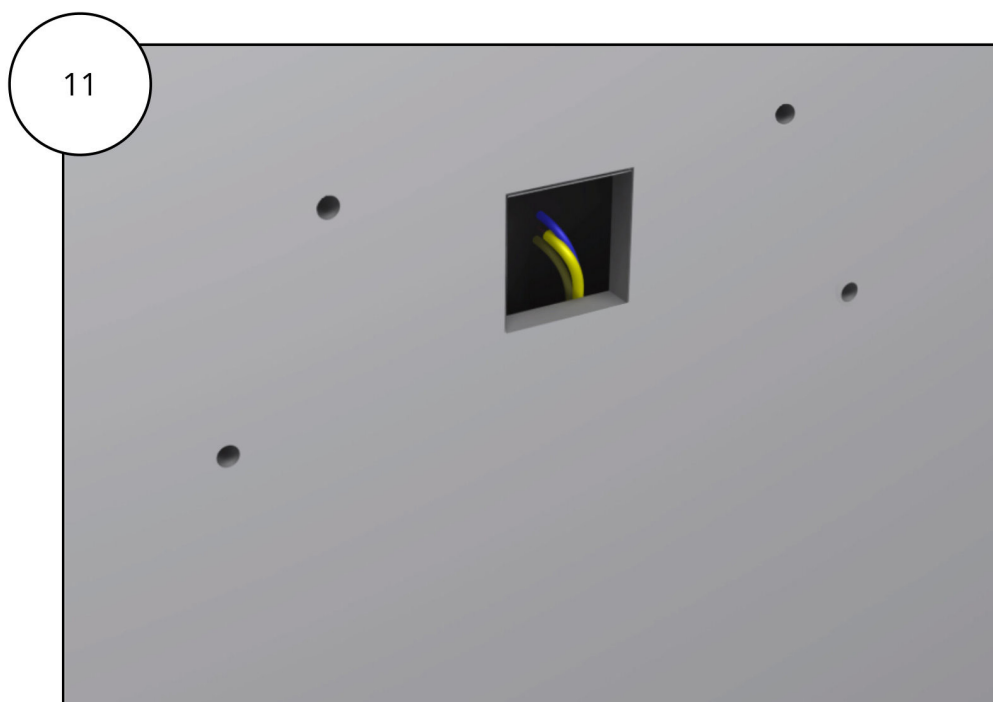

## DIAGRAMS & TECHNICAL DATA

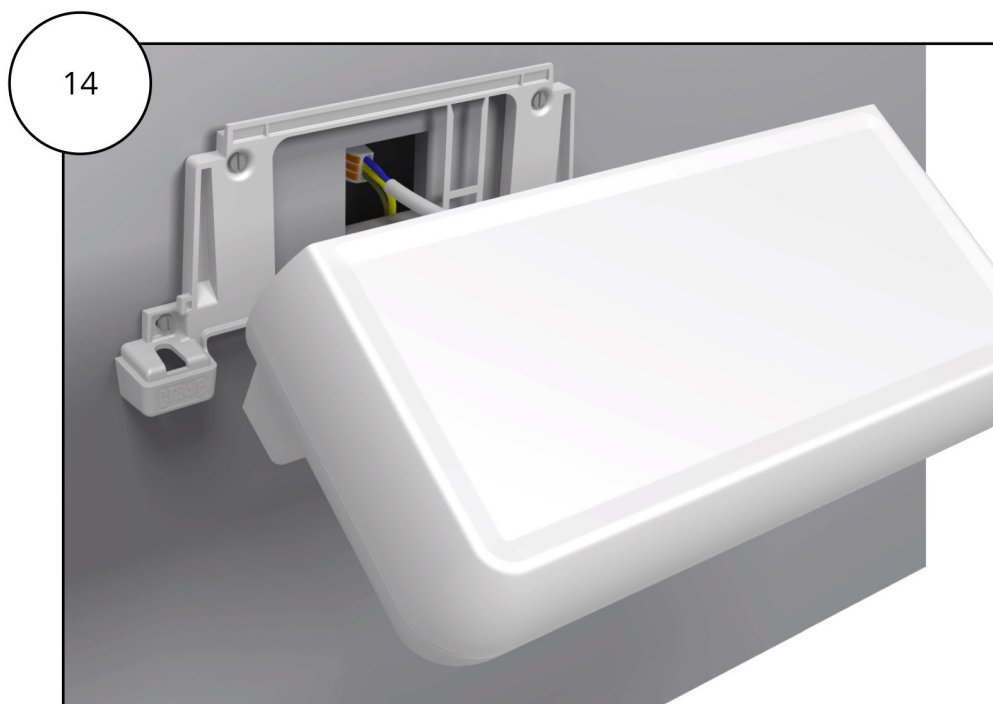
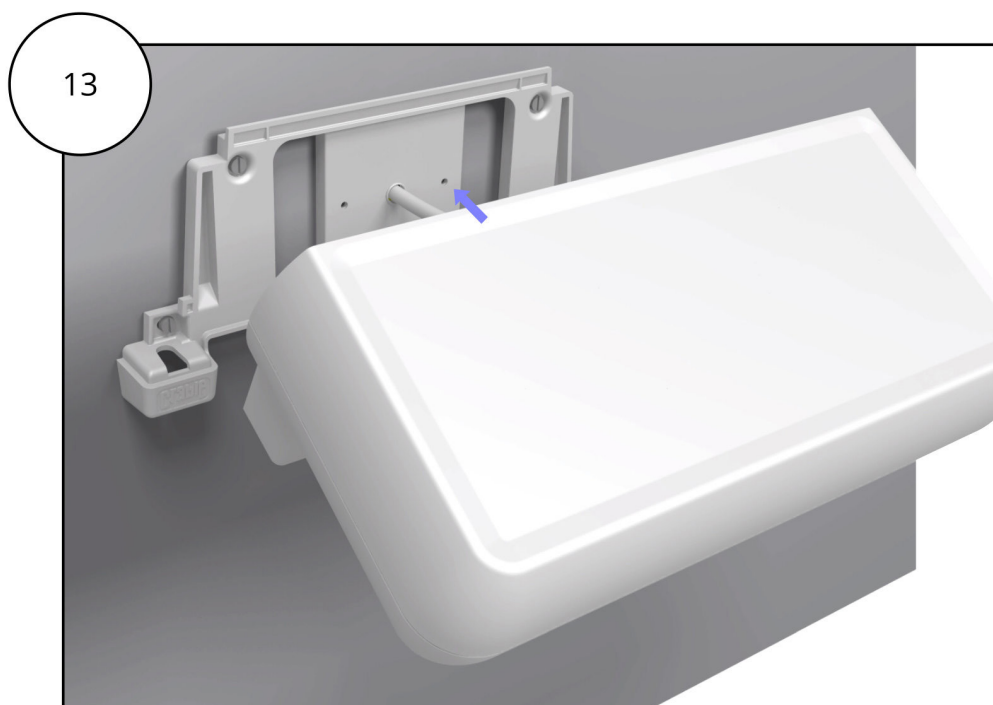

## DIAGRAMS & TECHNICAL DATA

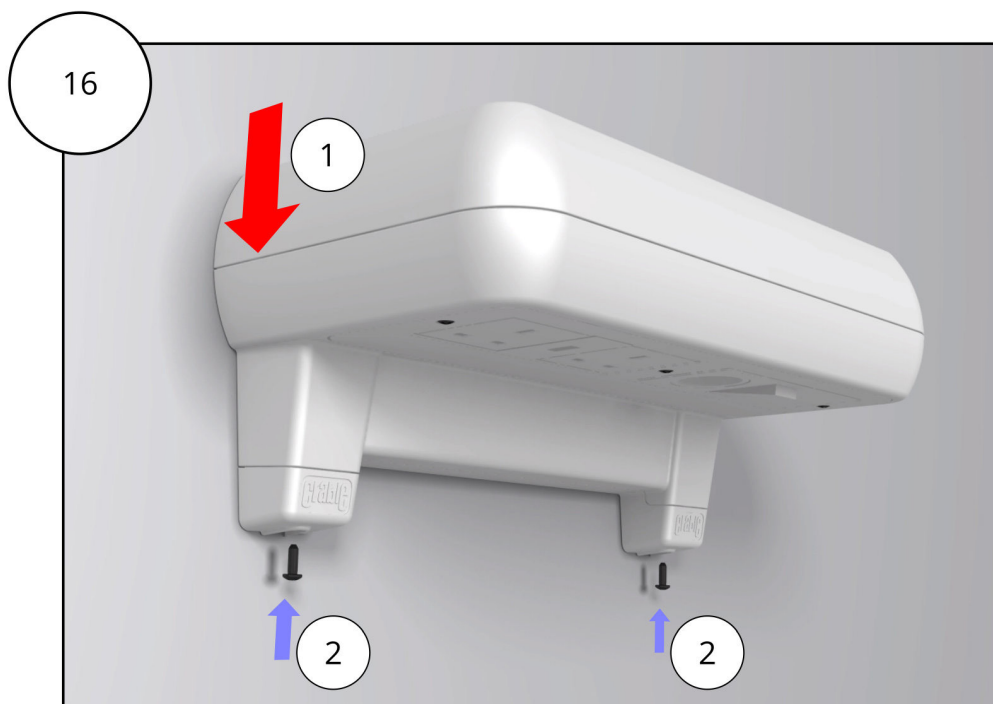
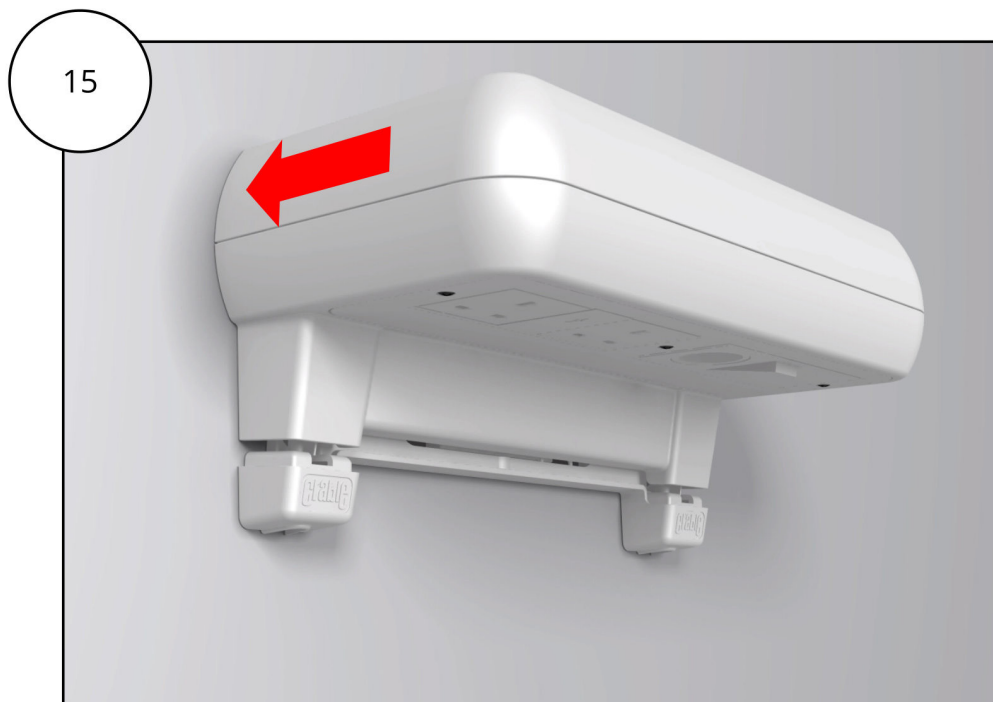



CRABLE.CO.UK



Patent Pending Under Patent Application Number GB1800827.  
Registered under Community Registered Design No. EM0056335356-0001

